 STEP-files S300

# S300



Serie 300

**Guide rail bracket**

Complete guide rail bracket including  
galvanized fasteners  
Black reinforced nylon  
Weight 220 g

**Part no. 300-0800**

B	A MAX	H MAX
S380	75	55
S620	100	50
S830	120	50
S140	120	50
S220	260	50

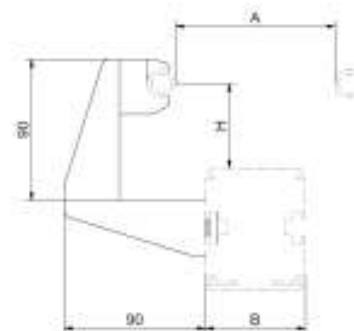

**Guide rail bracket**

Complete guide rail bracket including  
galvanized fasteners  
Black reinforced nylon  
Weight 250 g

**Part no. 300-0820**

B	A MAX	H MAX
S380	75	115
S620	100	110
S830	120	110
S140	120	110
S220	260	110



**Guide rail bracket**

Complete guide rail bracket including  
galvanized fasteners  
Black reinforced nylon  
Weight 250 g

**Part no. 300-0840**

B	A MAX	H MAX
S380	195	55
S620	220	50
S830	240	50
S140	240	50
S220	380	50

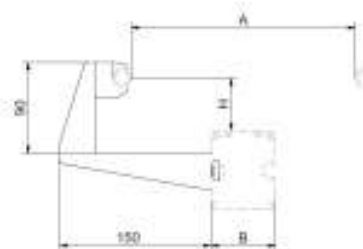

Serie 300

### Guide rail bracket

Complete guide rail bracket including  
galvanized fasteners  
Black reinforced nylon  
Weight 280 g

**Part no. 300-0860**

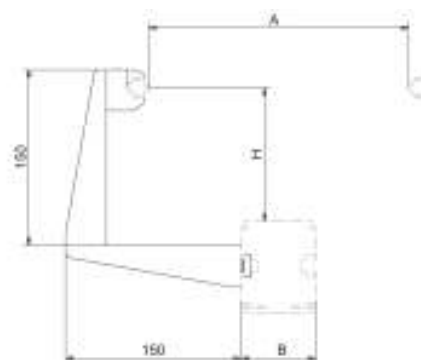

B	A MAX	H MAX
S380	195	115
S620	220	110
S830	240	110
S140	240	110
S220	380	110

### Guide rail bracket

Complete guide rail bracket including  
galvanized fasteners  
Black reinforced nylon and galvanized  
steel  
Weight 510 g

**Part no. 300-0920**

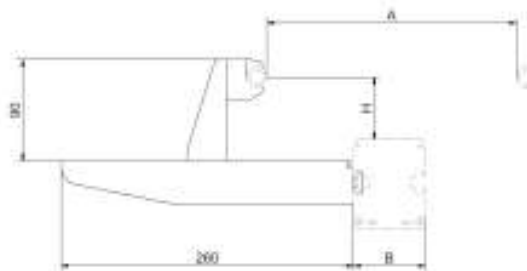

B	A MAX	H MAX
S380	410	55
S620	435	50
S830	455	50
S140	455	50
S220	595	50

Serie 300

**Guide rail bracket**

Complete guide rail bracket including  
galvanized fasteners  
Black reinforced nylon and galvanized  
steel  
Weight 540 g



**Part no. 300-0940**

B	A MAX	H MAX
S380	410	115
S620	435	110
S830	455	110
S140	455	110
S220	595	110

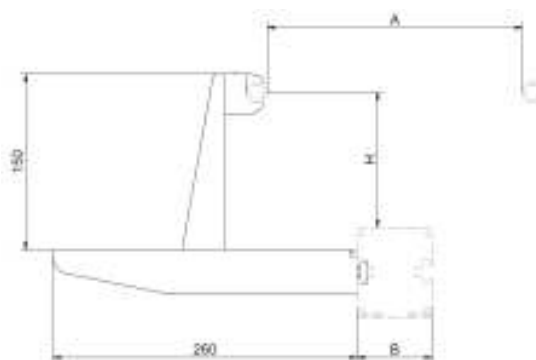

**Guide rail bracket**

Complete guide rail bracket including  
galvanized fasteners  
Black reinforced nylon and galvanized  
steel  
Weight 830 g



**Part no. 300-0960**

B	A MAX	H MAX
S380	410	225
S620	435	220
S830	455	220
S140	455	220
S220	595	220

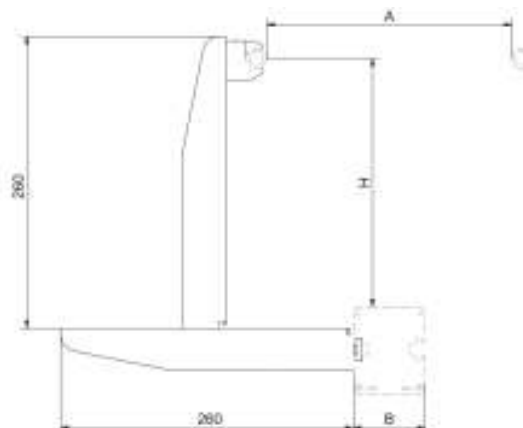

Serie 300

### Guide rail bracket

Complete guide rail bracket including galvanized fasteners  
Anodized aluminum and black reinforced nylon

Part no. 300-0880



A MAX			
B \ L	200	L = ...	
S380	295		
S620	320		
S830	340		
S140	340		
S220	480		

B	H MAX
S380	55
S620	50
S830	50
S140	50
S220	50



### Guide rail bracket

Complete guide rail bracket including galvanized fasteners  
Anodized aluminum and black reinforced nylon

Part no. 300-0900



A MAX			
B \ L	200	L = ...	
S380	295		
S620	320		
S830	340		
S140	340		
S220	480		

B	H MAX
S380	115
S620	110
S830	110
S140	110
S220	110

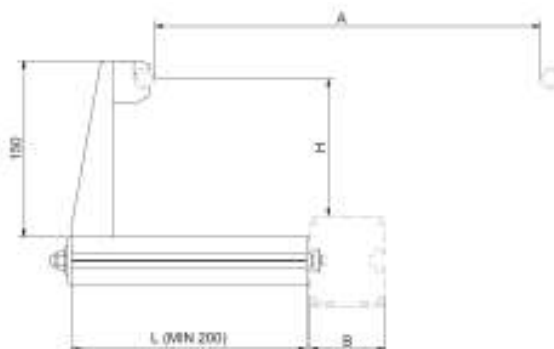

Serie 300

**Guide rail support**

Black reinforced nylon  
Including galvanized fasteners  
Weight 55 g

Part no. 300-1000

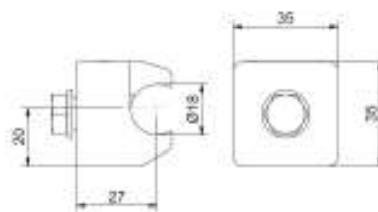

**Guide rail support**

Black acetal  
Weight 12 g

Part no. 300-1010

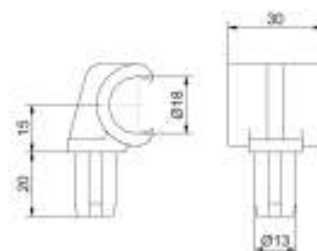

**Guide rail support**

Black acetal  
Weight 12 g

Part no. 300-1020

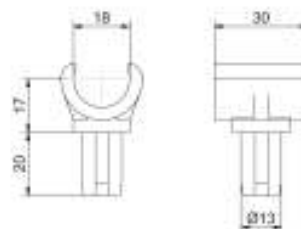

**Guide rail support**

Black acetal  
Weight 15 g

Part no. 300-1030

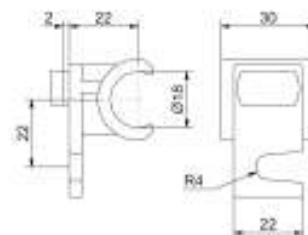

Serie 300

**Guide rail support**

For guide rail bracket 300-2160 and 300-2165  
Black acetal  
Weight 12 g

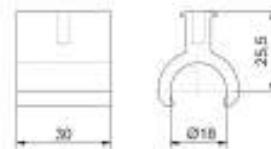

**Part no. 300-1035**

**Guide rail support**

For guide rail bracket 300-2160 and 300-2165  
Black acetal  
Weight 17 g

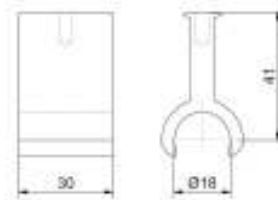

**Part no. 300-1036**

Serie 300

### Guide rail bracket

Guide rail bracket for S620  
Anodized aluminum  
Weight 165 g

Art.nr 300-2160

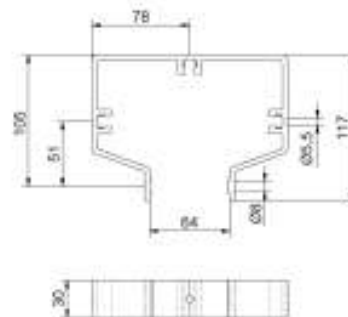

### Guide rail bracket

Guide rail bracket for 300-1035 and  
300-1036  
Anodized aluminum  
Weight 42 g

Part no. 300-2165

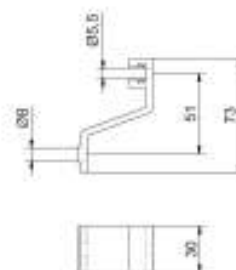

### Spacer

Spacer for 300-2165  
Anodized aluminum  
Weight 9 g

Part no. 300-2170

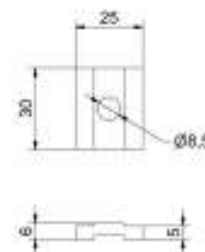



Serie 300

**Guide rail support**

Black reinforced nylon  
Including galvanized fasteners  
Weight 50 g

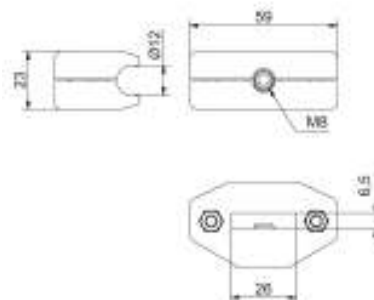

**Part no. 300-1045**

**Guide rail support**

For guide rail 300-3030  
Black reinforced nylon  
Weight 15 g

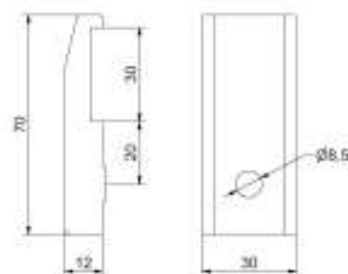

**Part no. 300-1050**

**Guide rail support**

For guide rail profile 300-3050  
Black reinforced nylon  
Including galvanized fasteners  
Weight 28 g

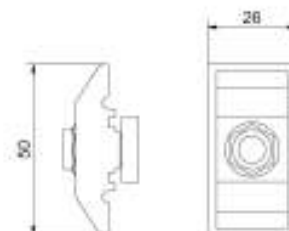

**Part no. 140-1025**

**Guide rail support**

Black reinforced nylon  
Including galvanized fasteners  
Weight 35 g

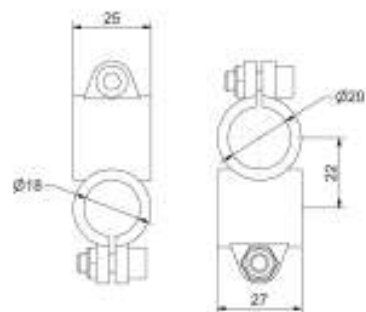

**Part no. 300-1090**

Serie 300

**Adapter plate**

Adapter plate for guide rail bracket  
in curve S140  
Black reinforced nylon  
Weight 15 g

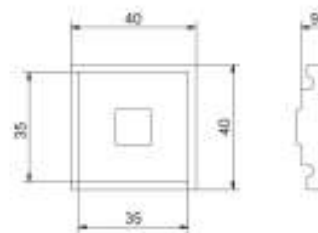

**Part no. 300-2040**

**Spacer**

For all angle brackets in nylon  
Black reinforced nylon  
Weight 40 g

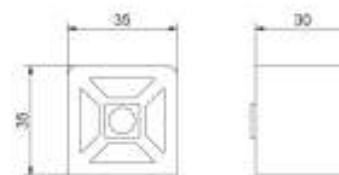

**Part no. 300-2030**

**Angle bracket**

Black reinforced nylon  
Weight 58 g

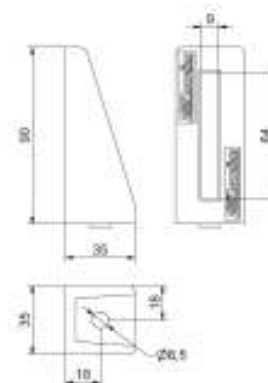

**Part no. 300-2090**

**Angle bracket**

Black reinforced nylon  
Weight 90 g

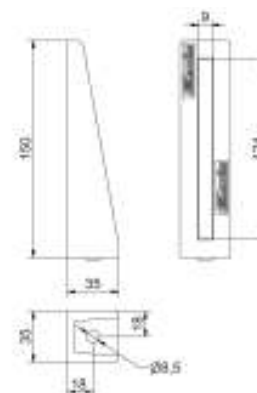

**Part no. 300-2150**

Serie 300

**Angle bracket**

Galvanized steel  
Weight 375 g

Part no. 300-2260

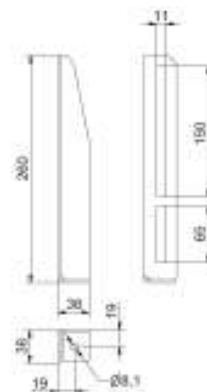

**Angle bracket**

Angle bracket for photocell  
Black acetal  
Weight 36 g

Part no. 300-2900

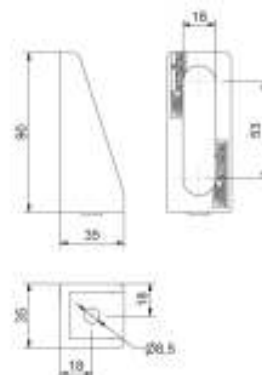

**Angle bracket**

Angle bracket for photocell  
Black acetal  
Weight 52 g

Part no. 300-2910

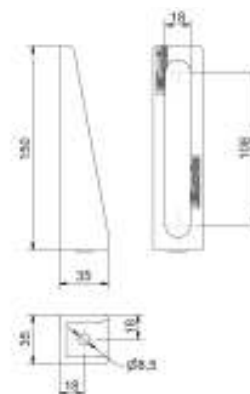

Serie 300

**Guide rail**

Anodized aluminum  
Weight 330 g/m  
Length 5.8 m

**Part no. 300-3000**

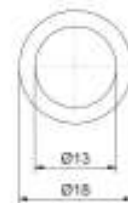

**Guide rail with slide rail**

Anodized aluminum and nylon  
Weight 430 g/m  
Length 5.8 m

**Part no. 300-3010**

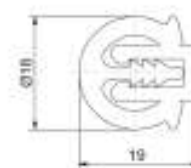

**Guide rail**

Anodized aluminum  
Weight 410 g/m  
Length 5.8 m

**Part no. 300-3030**



**Guide rail**

Guide rail for palett 200-7020  
Anodized aluminum  
Weight 370 g/m  
Length 5.8 m

**Part no. 300-3050**

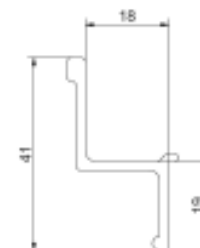

Serie 300

**Guide rail**

Anodized aluminum  
Weight 470 g/m  
Length 5.8 m

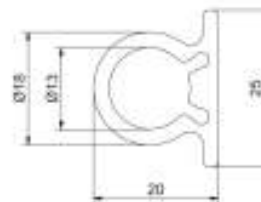

**Part no. 300-3040**

**Plastic strip**

For guide rail 300-3040  
White nylon  
Weight 150 g/m  
Length 12 m

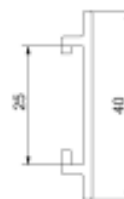

**Part no. 300-3045**

**Plastic strip**

For guide rail 300-3040  
White nylon  
Weight 270 g/m  
Length 12 m

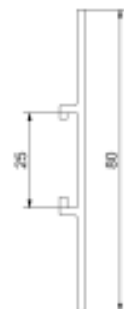

**Part no. 300-3047**

**Serie 300**

**Brush**

Brush made of nylon and galvanized steel brackets  
Weight 240 g

**Art.nr 300-3061**

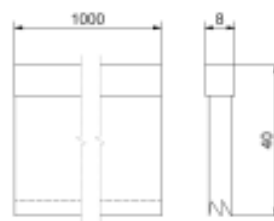

**Brush**

Brush made of nylon and galvanized steel brackets  
Weight 390 g

**Art.nr 300-3062**



**Bracket F-profile**

For brush 300-3062  
Aluminum  
Weight 280 g

**Art.nr 300-3065**

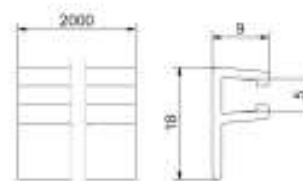

**Bracket H-profil**

For brush 300-3062  
Aluminum  
Weight 320 g

**Art.nr 300-3066**

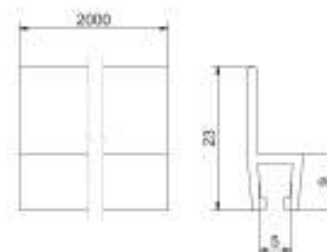
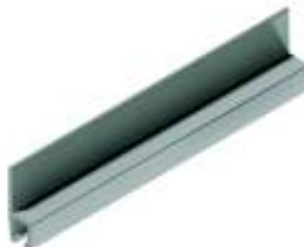

Serie 300

### Bracket F-profile

For brush 300-3061  
Aluminum  
Weight 290 g

Part no. 300-3067

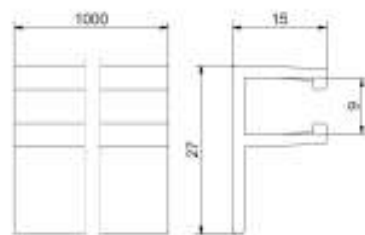

### Bracket H-profile

For brush 300-3061  
Aluminum  
Weight 320 g

Part no. 300-3068

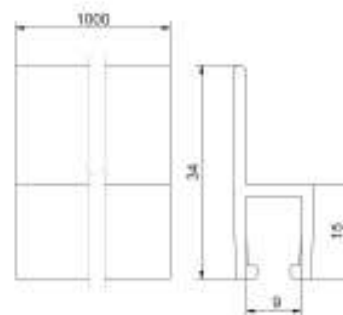

### Connecting strip

For F-profile 300-3065  
Anodized aluminum  
Weight 15 g

Part no. 300-3064

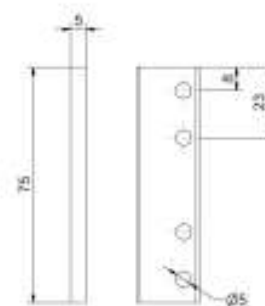

Serie 300

**Connecting sleeve**

For guide rail  
Anodized aluminum  
Weight 15 g

**Part no. 300-3091**

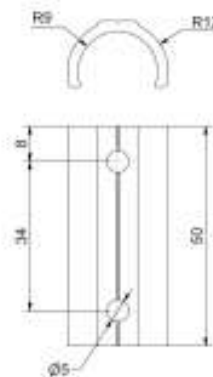

**Screw**

For connecting sleeve 300-3091 and  
connecting strip 300-3065  
Galvanized steel  
Weight 3 g

**Part no. 300-3095**



**End cap**

For guide rail 300-3000 and 300-3040  
Black polypropylene  
Weight 2 g

**Part no. 300-3070**

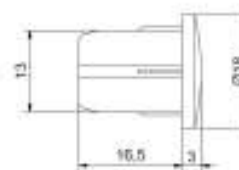

**End cap**

For guide rail 300-3010  
Black acetal  
Weight 2 g

**Part no. 300-3075**

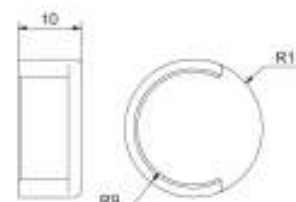



Serie 300

**Guide rail bracket**

For guide rail 300-3000  
 Black reinforced nylon  
 Including galvanized fasteners  
 Weight 130 g

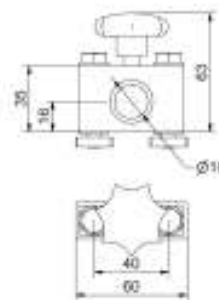

**Part no. 300-3200**

**Hand wheel**

Black thermoplastic and brass bushing  
 Weight 15 g



**Part no. 300-3250**

**Hand wheel**

Black thermoplastic and brass bushing  
 Weight 24 g



**Part no. 300-3260**

**Clamping lever**

Black thermoplastic and galvanized steel  
 Weight 32 g

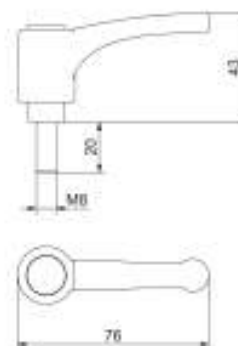

**Part no. 300-3300**

Serie 300

**Cam lever**

Black thermoplastic and galvanized steel  
Weight 33 g

**Part no. 300-3310**

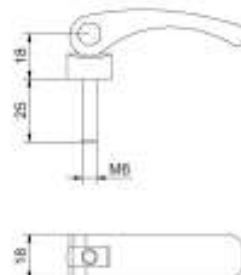

**Spacer tube**

Anodized aluminum  
Weight 750 g/m  
Length 5.8 m

**Part no. 300-4010**

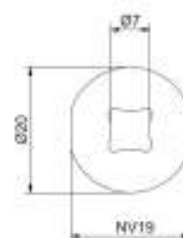

**Support bracket**

Support bracket for 300-4010  
Black reinforced nylon  
Weight 4 g

**Part no. 300-4020**



**End cap**

For spacer tube 300-4010  
Black polypropylene  
Weight 2 g

**Part no. 300-4030**

